



Opzs Series

BSB Opzs Series Lead Acid batteries are designed with a combination of die-casting Tubular positive framework and superfluous electrolyte technologies to offer a very high lever of reliability and a long service life. Opzs batteries used special filter and proof design to ensure no acid fog runs over and burning proof, and also convenient examine and maintenance.

Application

- | | |
|--------------------|---------------------------|
| Telecommunications | Medical Equipment |
| Cable Television | UPS |
| Electric Utility | Railroad Utility |
| Control Equipment | Photovoltaic System |
| Security System | Alternative Energy System |

General Features

- Maintenance convenient.
- Non-Spillable construction design.
- Transparent containers, convenient to observe.
- Special filter installation for acid fog proof.
- High quality and high reliability.
- Super long service life.
- Special pole sealed technology.
- Super reliability.

Construction

- | | | | |
|-----------|-------------------|-------------|--------------------|
| Component |Raw material | Terminal |Copper |
| Positive |Lead dioxide | Separator |Rubber-PVC |
| Negative |Lead | Electrolyte |Sulfuric acid |
| Container |AS | | |
| Cover |AS | | |

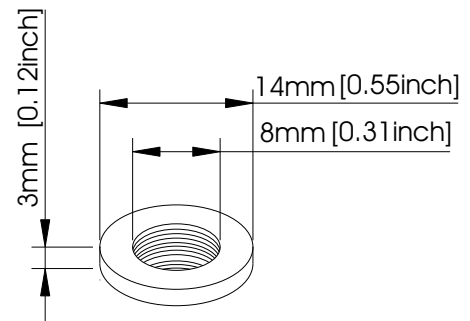

Terminal Dimensions

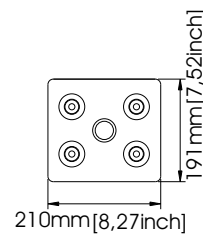

| | | | | |
|----------------------------------|---|-----------------|------------------------------------|------------------|
| Battery Model | OPzS 2-800 | | | |
| Designed Floating Life | 15 Years | | | |
| Capacity(25°C) | 24HR(40.6A,1.85V) | 10HR(80A,1.80V) | 5HR(137.5A,1.77V) | 1HR(416A,1.67V) |
| | 975AH | 800AH | 688AH | 416AH |
| Dimensions | Length | Width | Height | Total Height |
| | 191mm(7.52inch) | 210mm(8.27inch) | 645mm(25.39inch) | 700mm(27.56inch) |
| Approx. Weight | Without electrolyte:45.3 Kg (99.89 lbs) | | with electrolyte: 61.3Kg(135.2lbs) | |
| Internal Resistance | Full charged at 25°C: 0.0006 Ohm | | | |
| Self Discharge | 3% of capacity declined per month at (25°C) | | | |
| Capacity Affected by Temp.(20HR) | 40°C | 25°C | 0°C | -15°C |
| | 102% | 100% | 85% | 65% |
| Charge Voltage(25°C) | Cycle use | | Float use | |
| | 2.35V-2.4V(-5mV/ °C), max. Current: 120A | | 2.24V(-3.3mV/ °C) | |

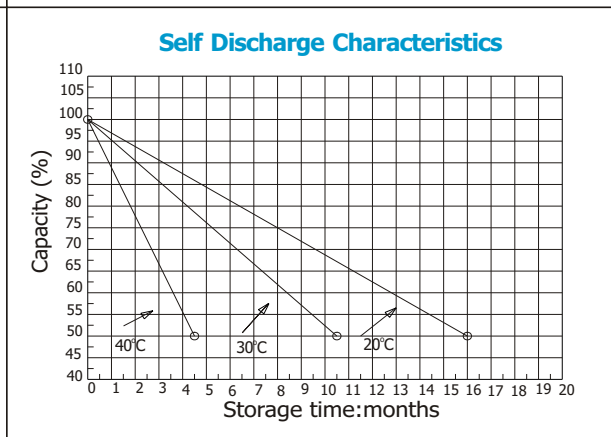
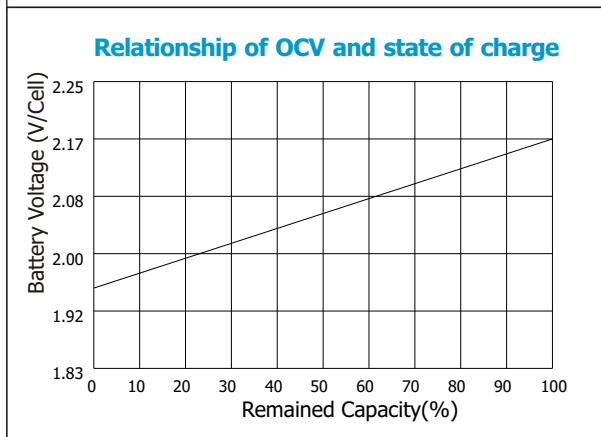
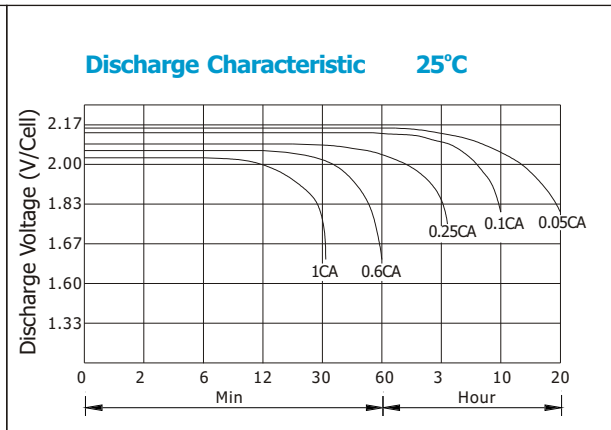
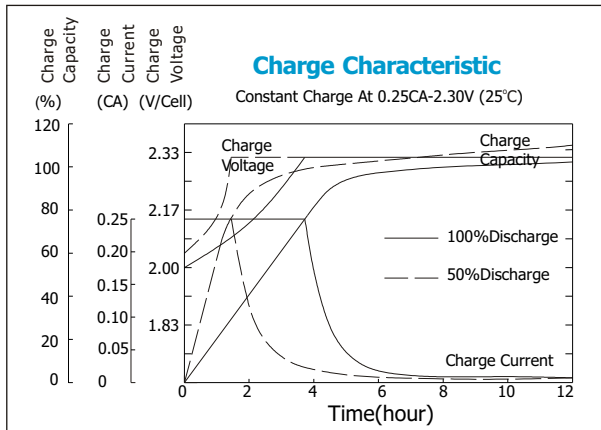

Constant current discharge ratings-amperes at 25°C

| TIME | 1HR | 3HR | 5HR | 10HR | 24HR | 48HR | 72HR | 96HR | 120HR | 240HR |
|-----------------|------|------|------|------|------|------|------|------|-------|-------|
| CUT-OFF VOLTAGE | 1.67 | 1.75 | 1.77 | 1.80 | 1.85 | 1.85 | 1.85 | 1.85 | 1.85 | 1.85 |
| CAPACITY(AH) | 416 | 600 | 688 | 800 | 975 | 1072 | 1150 | 1155 | 1160 | 1175 |

Constant power discharge ratings-watts at 25°C

| TIME | 1HR | 3HR | 5HR | 10HR | 24HR | 48HR | 72HR | 96HR | 120HR | 240HR |
|-----------------|------|------|------|------|------|------|------|------|-------|-------|
| CUT-OFF VOLTAGE | 1.67 | 1.75 | 1.77 | 1.80 | 1.85 | 1.85 | 1.85 | 1.85 | 1.85 | 1.85 |
| CAPACITY(WH) | 686 | 1104 | 1335 | 1488 | 1755 | 1801 | 1932 | 1940 | 1948 | 1974 |

