



### EVX SERIES

BSB EVX Series batteries are designed to have a large amount of stored current discharged between charging sessions, with very heavy non-porous battery plates to withstand repeated major discharging and charging cycle (deep cycles). The BSB EVX batteries uses a different chemistry for the plates active paste material, and a slightly stronger electrolyte than normal battery electrolyte, which allows for a much longer life in deep cycle applications.

### Application

- Electric Powered Vehicles
- Golf Cars and Buggies
- Wheel Chairs
- Power Tools
- Electric Powered Toys
- Control System
- Vacuum Cleaners
- Medical Equipments
- UPS
- Pvs

### General Features

- Sealed and maintenance free operation.
- Non-Spillable construction design.
- ABS containers and covers(UL94HB, UL94V-0) optional.
- Safety valve installation for explosion proof.
- High quality and high reliability.
- Exceptional deep discharge recovery performance.
- Low self discharge characteristic.
- Flexibility design for multiple install positions.

### Construction

- Component .....Raw material
- Positive .....Lead dioxide
- Negative .....Lead
- Container .....ABS
- Cover .....ABS
- Sealant .....Epoxy Resin
- Safety valve ....EPDR
- Terminal .....Copper
- Separator .....Fibre glass
- Electrolyte .....Sulfuric acid

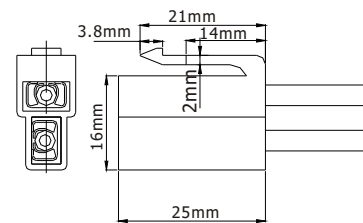

### Terminal Dimensions

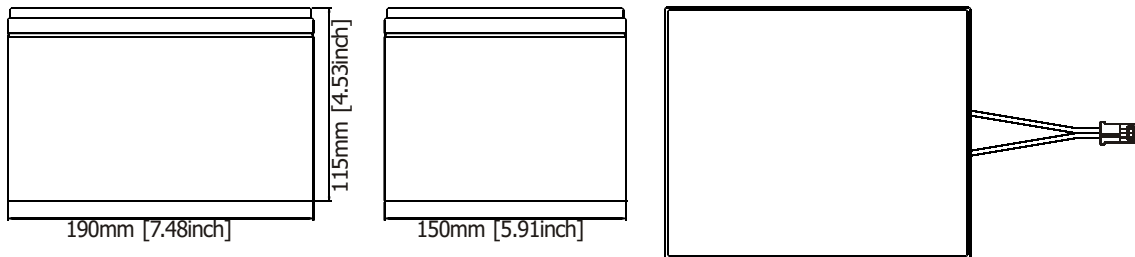

Battery Model	EVX24-16			
Designed Cycle Life	> 350 cycles @ 100% DOD			
Capacity(25°C)	20HR(0.8A,1.75V)	10HR(1.5A,1.75V)	2HR(7A,1.75V)	1HR(9.6A,1.75V)
	16AH	15AH	14AH	9.6AH
Dimensions	Length	Width	Height	Total Height
	190mm(7.48inch)	150mm(5.91inch)	115mm(4.53inch)	115mm(4.53inch)
Approx. Weight	9.4 Kg (20.73 lbs)			
Internal Resistance	Full charged at 25°C: 0.03 Ohm			
Self Discharge	3% of capacity declined per month at (25°C)			
Capacity Affected by Temp.(20HR)	40°C	25°C	0°C	-15°C
	102%	100%	85%	65%
Charge Voltage(25°C)	Cycle use		Float use	
	27.1V(-55mV/ °C), max. Current: 4.5A		25.3V(-35mV/ °C)	

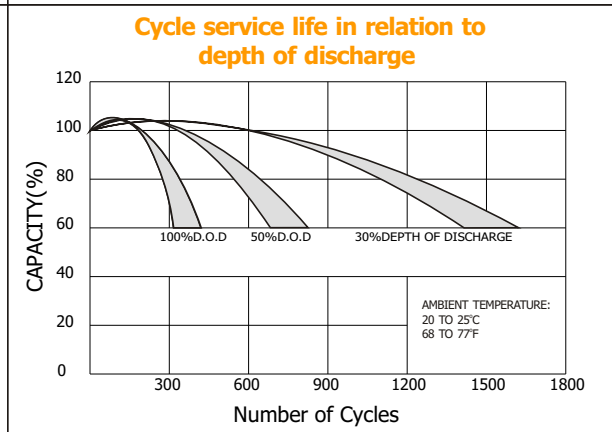
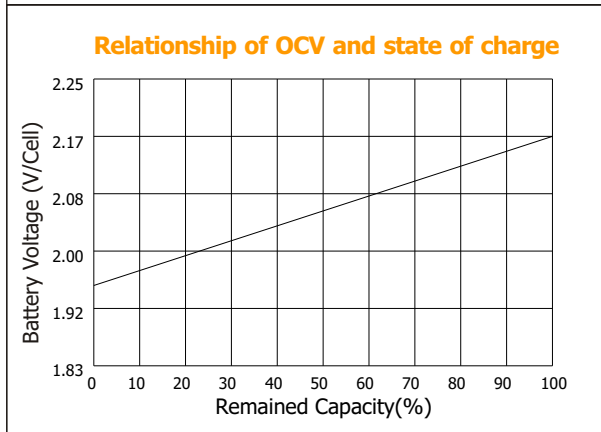
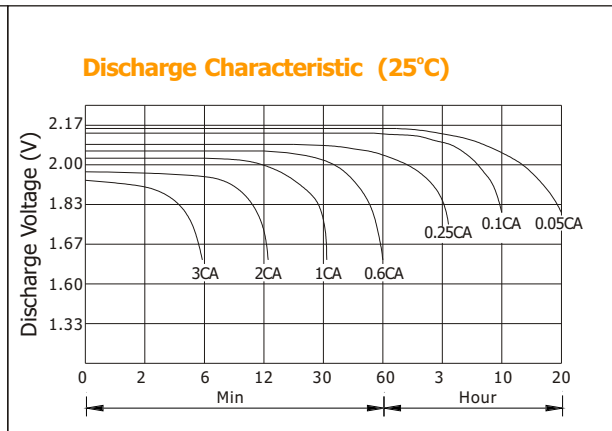
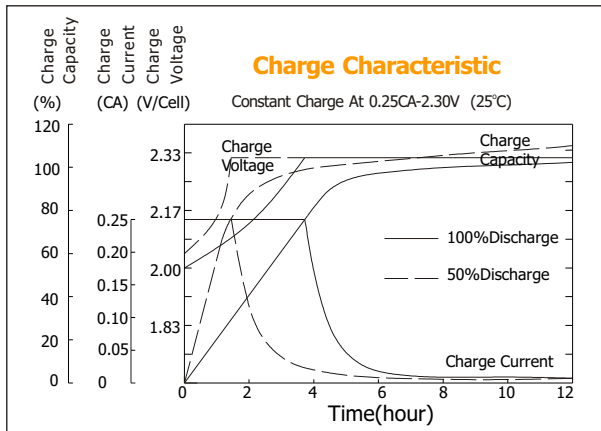

**Constant current discharge ratings-amperes at 25°C**

F. V/Time	5MIN	10MIN	15MIN	30MIN	1HR	3HR	5HR	10HR	20HR
1.60V	62.5	38.9	29.3	17.9	11.4	4.99	3.05	1.71	0.90
1.67V	58.7	36.9	28.2	17.1	11.2	4.80	2.99	1.69	0.87
1.70V	53.8	35.6	27.6	15.6	10.9	4.48	2.92	1.68	0.85
1.75V	52.7	34.4	26.7	14.8	10.4	4.33	2.86	1.66	0.83
1.80V	47.1	32.9	24.2	13.7	9.71	4.16	2.69	1.64	0.81
1.85V	41.6	31.3	21.8	12.6	9.05	4.01	2.52	1.62	0.79

**Constant power discharge ratings-watts at 25°C**

F. V/Time	5MIN	10MIN	15MIN	30MIN	1HR	3HR	5HR	10HR	20HR
1.60V	110	70.2	53.6	32.2	20.5	8.85	5.16	3.41	1.79
1.67V	106	68.4	52.9	31.6	20.4	8.58	5.13	3.39	1.73
1.70V	99.6	67.8	52.4	29.6	20.0	8.19	5.07	3.37	1.71
1.75V	94.0	67.6	52.0	28.7	19.7	8.00	5.02	3.33	1.66
1.80V	91.7	66.6	48.2	27.3	18.5	7.77	4.87	3.29	1.62
1.85V	83.2	63.1	43.7	25.6	17.4	7.53	4.71	3.24	1.56

